

Standard Specifications	
Adjust screw rotation	Approx. 8-12 turns
Max. working pressure	1.0MPa(G)
Needle type	#8, #9, #10
Materials of areas in contact with fluid	(A) Al, Brass, POM, NBR, 316 stainless steel (SS) 316 stainless steel, PCTFE, FKM
Fluids	Gas, liquid
Connection end	Rc3/8 (Standard), Rc1/4 (Optional)

Dwg. No.	FR330009A1	MODEL
Name	Large precision needle valve	2412D
Customer		
MODEL: 2412D-		
Specifications		
Fluid:		
Max Flow rate:		
Material:		
Connection:		
Inlet-Outlet		
Pressure difference:		
Remarks:		

Cut Out Dimension

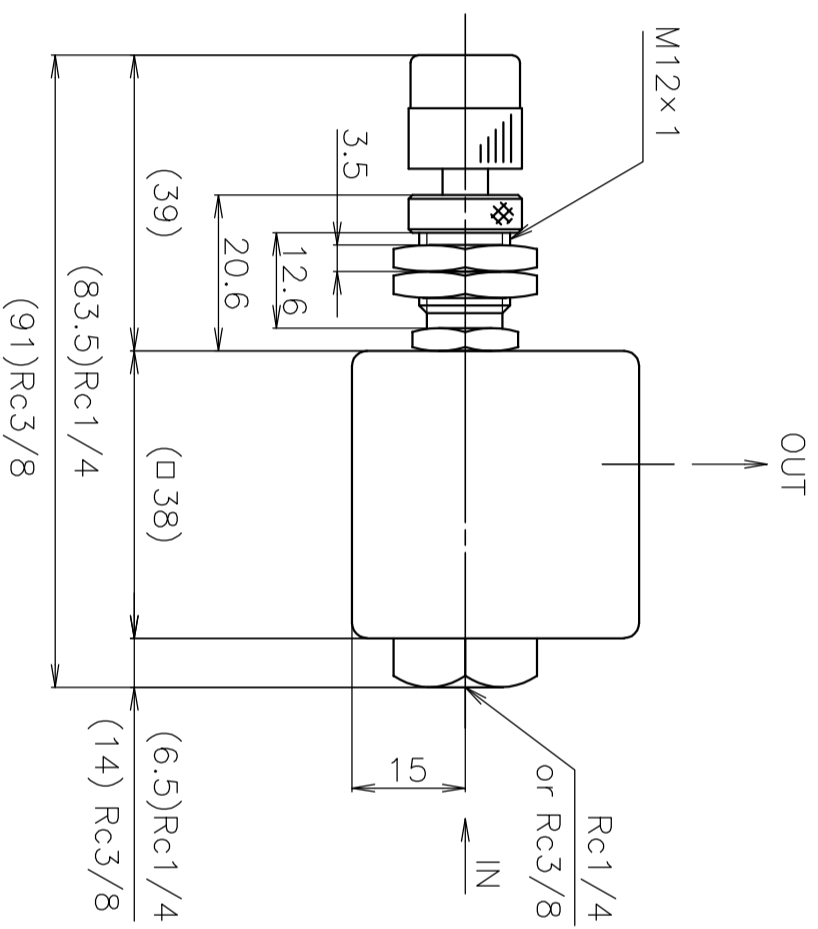
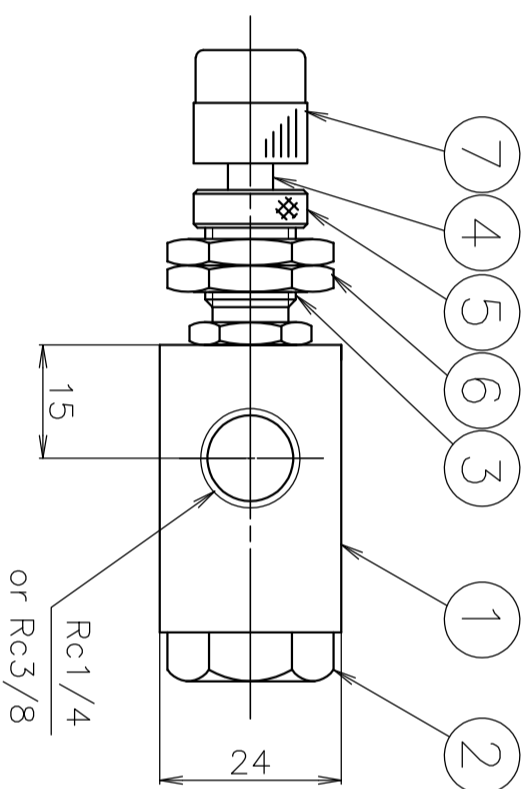
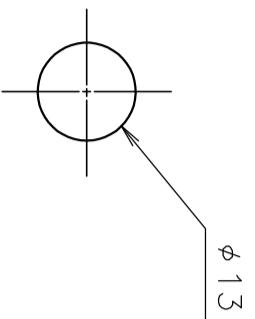

7	Knob	ABS	1	
6	Mounting nut	Brass	1	
5	Cap nut	Brass	1	
4	Needle axis	303 Stainless steel	1	
3	Needle body	316 Stainless steel	1	
2	Orifice port	Brass	2	
1	Main unit	Al63S	1	
No.	NAME	A	SS	Qt.
SPECIFICATION				
SCALE 1/1				
3RD ANGLE PROJ. R E V				

KOFLOC Corp.

DESIGNED	DRAWN	CHECKED	APPROVED

Dimension in mm size

DATE / /